



Stormtech is the only linear drainage system available with full Greentag and Watermark certification across our complete product range.





ARCHITECTURAL
GRATES + DRAINS



38PSi40MTL

Linear Drainage System



Code 38PSi40MTL

Range 38

Grate Style PS

Category Made-to-Length

Channel Material Stainless Steel

Steel Grade 316

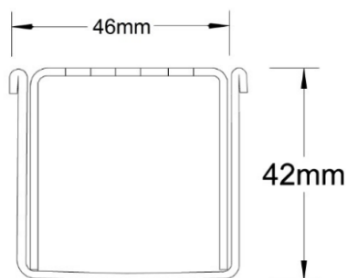

Grates longer than 1500mm supplied in sections.
Tile Inserts longer than 1200mm supplied in sections.
Channels over 3000mm supplied in sections with joiner.

The 38PSi40 is a Punched Slot grate design.

Manufactured from 316 marine grade the 38PS is 38mm wide and 40mm deep. All stainless steel drainage unit made to specified length with specified outlet position.

Refer to AS3500 for outlet pipe sizes specific to your installation.

SPECIFICATIONS + DIMENSIONS

Channel Width	46mm
Channel Depth	42mm
Length(s)	As Required
Outlet Size	DN40

STORMTECH COLOUR FINISHES



Electroplate finishes subject to natural variation with time and local environment.

PRODUCT APPLICATIONS

Bathroom Drainage	Hospitality Drainage
Aged / Health Care Drainage	Paved Area Drainage
Balcony Drainage	Shower Drainage
Commercial Drainage	Multi-Residential Drainage
Courtyard / Patio Drainage	Special Needs Drainage
Pool and Spa Area Drainage	Threshold Drainage

Copyright © Stormtech Pty Ltd. Patent 733361. Drawings not to scale, please use dimensions shown.



Visit **stormtech.com.au**
for tools + inspiration.

Phone **1300 653 403**

Email **info@stormtech.com.au**

38MTL Bathroom DN 40 outlet.

For 38ARi40MTL, 38PHi40MTL, and 38PSi40MTL



NOTE, refer to AS3500 for specific outlet pipe sizes related to your specific installation.

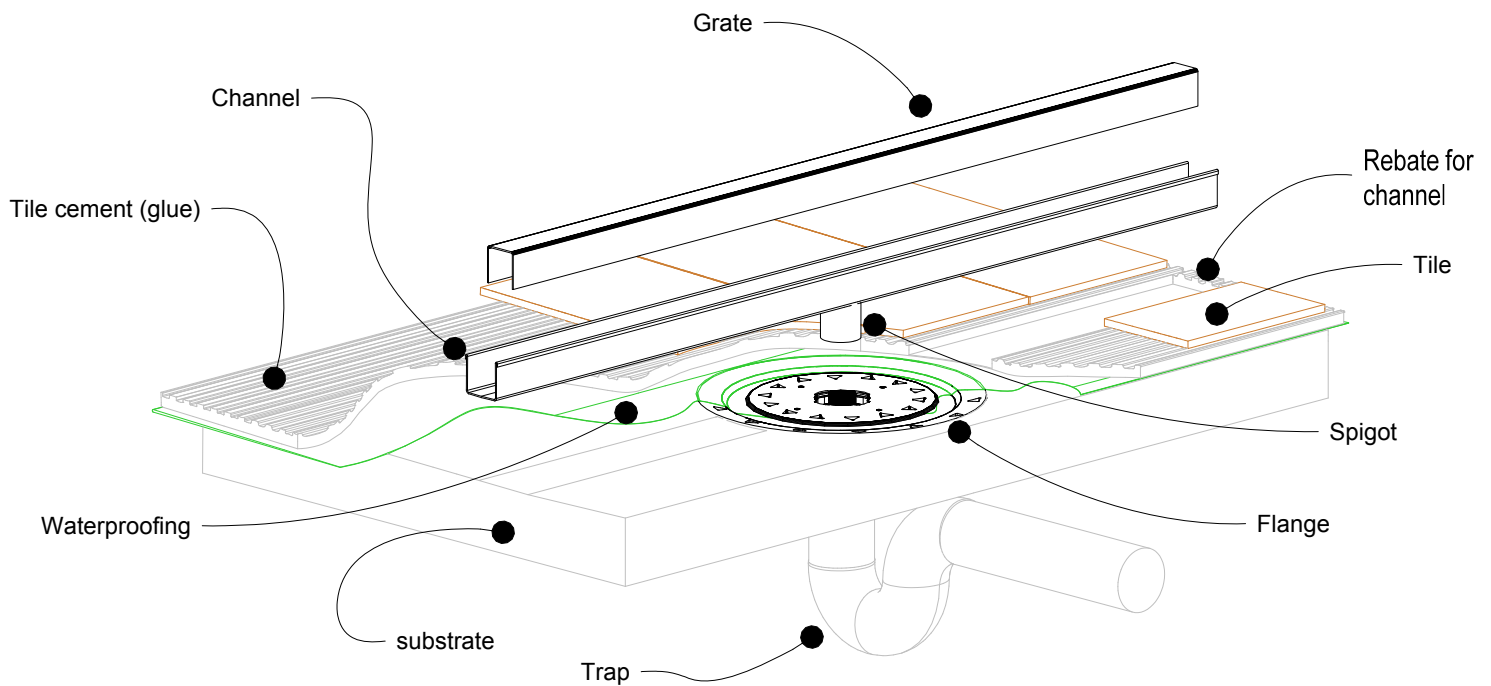

NOTE, this method requires the channel system to be above and separate from the waterproofing

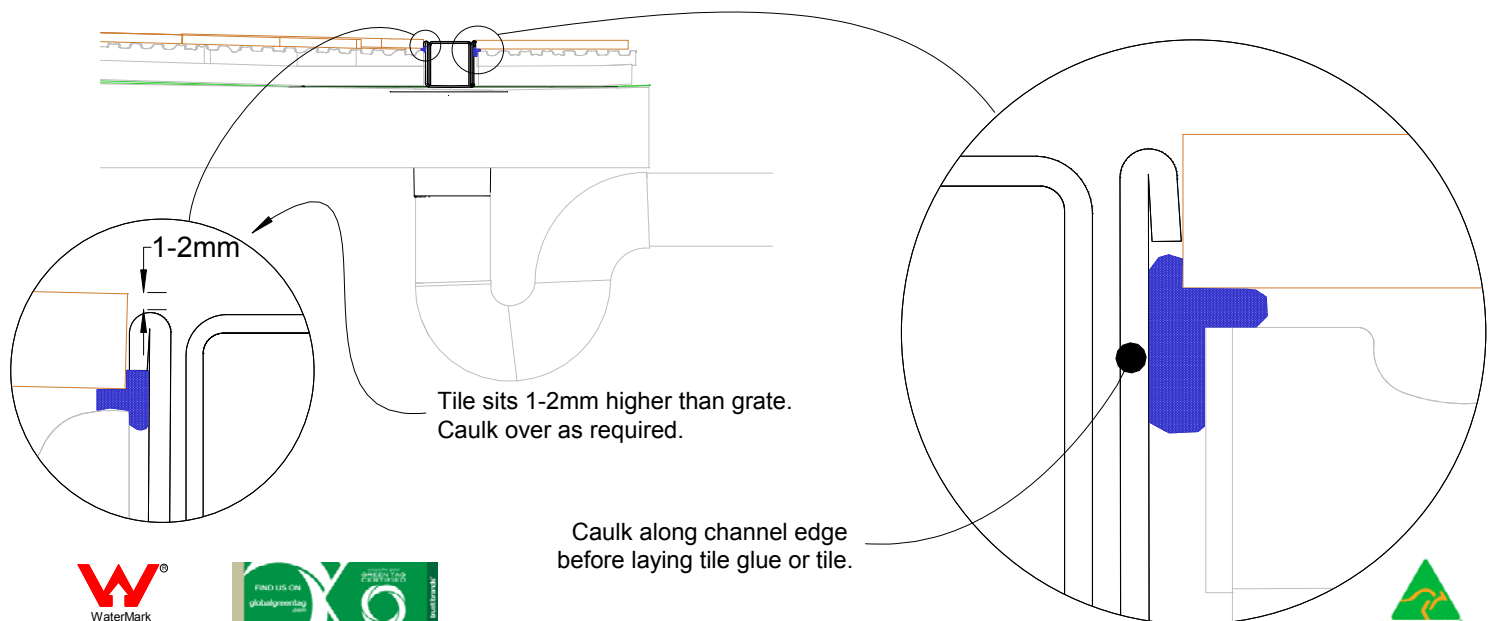

38MTL Concrete Floor or Deck

For 38ARi409MTL, 38PSi40MTL and 38PHi40MTL



Slab on Ground

Waterproofing is fixed to the floor flange

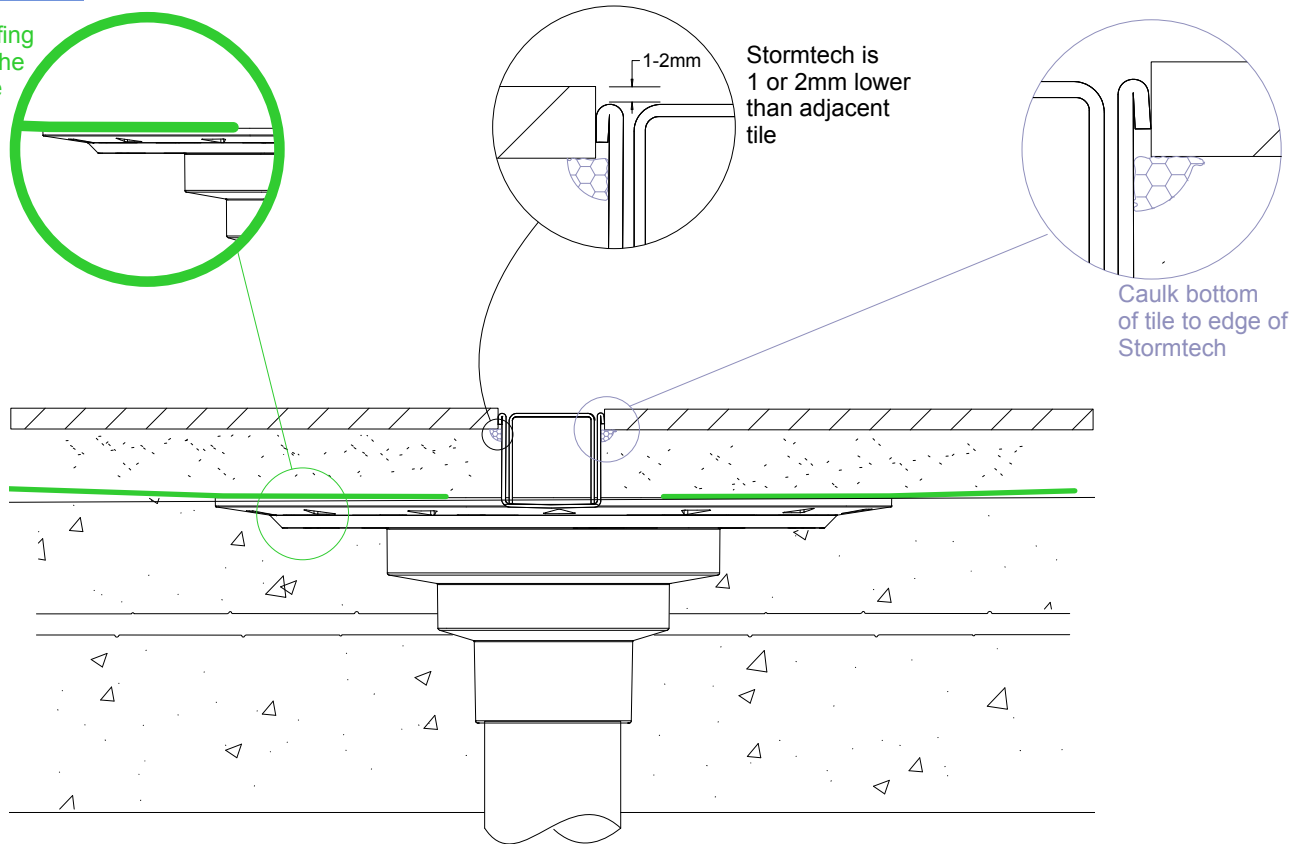

Suspended Slab

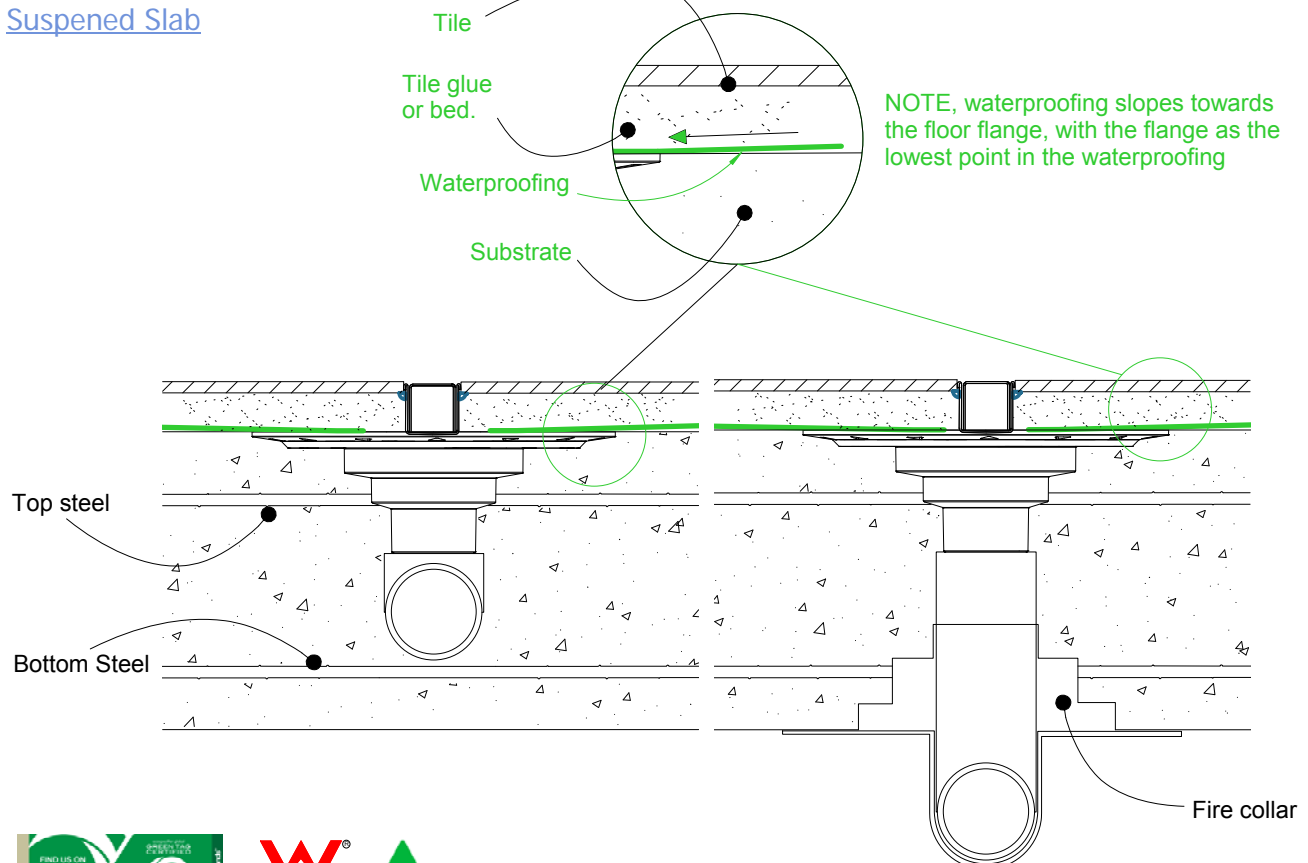

38MTL Threshold installation suggestion

For 38ARi409MTL, 38PSi40MTL and 38PHi40MTL



Standard hinged door

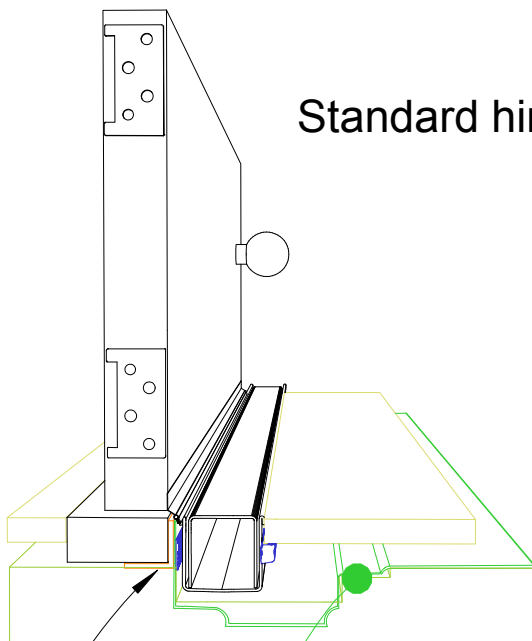

Aluminium angle to support waterproofing and junction between channel and door sil.

Top hung slider

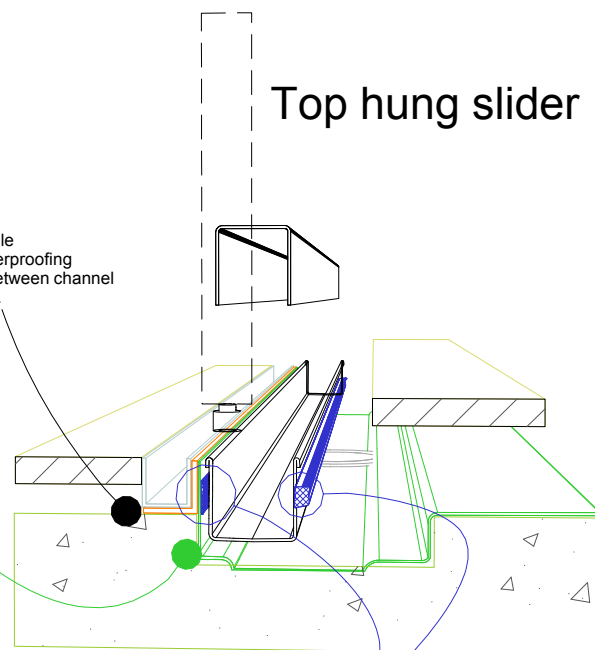

Aluminium angle to support waterproofing and junction between channel and door track.

Waterproofing

Bi-fold door

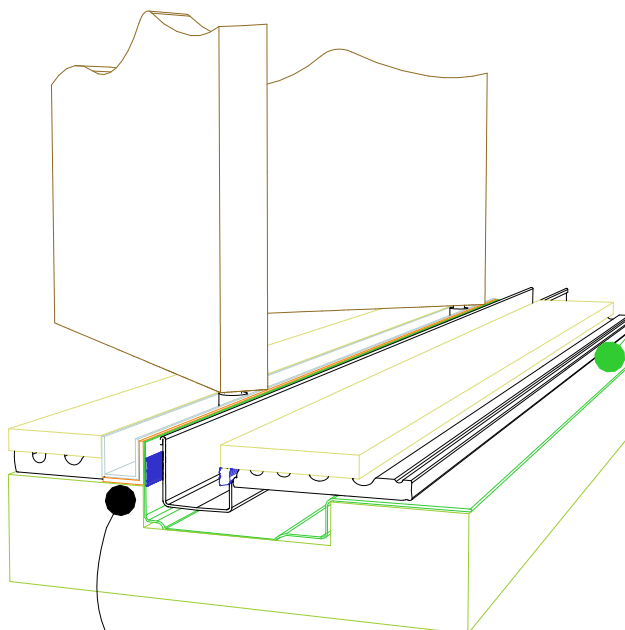

Aluminium angle to support waterproofing and junction between channel and door track.

For all types of threshold installation ensure both sides of the channel are sealed before laying tile.

NOTE, ALWAYS ensure the waterproofing is completed before laying the Stormtech.

NOTE, ensure weather stip is used on the appropriate side of the door to ensure drafts and moisture are minimised.



38MTL TIMBER FLOOR/DECK

For 38ARi409MTL, 38PSi40MTL and 38PHi40MTL



When 38MTL is running parallel to joist/bearer

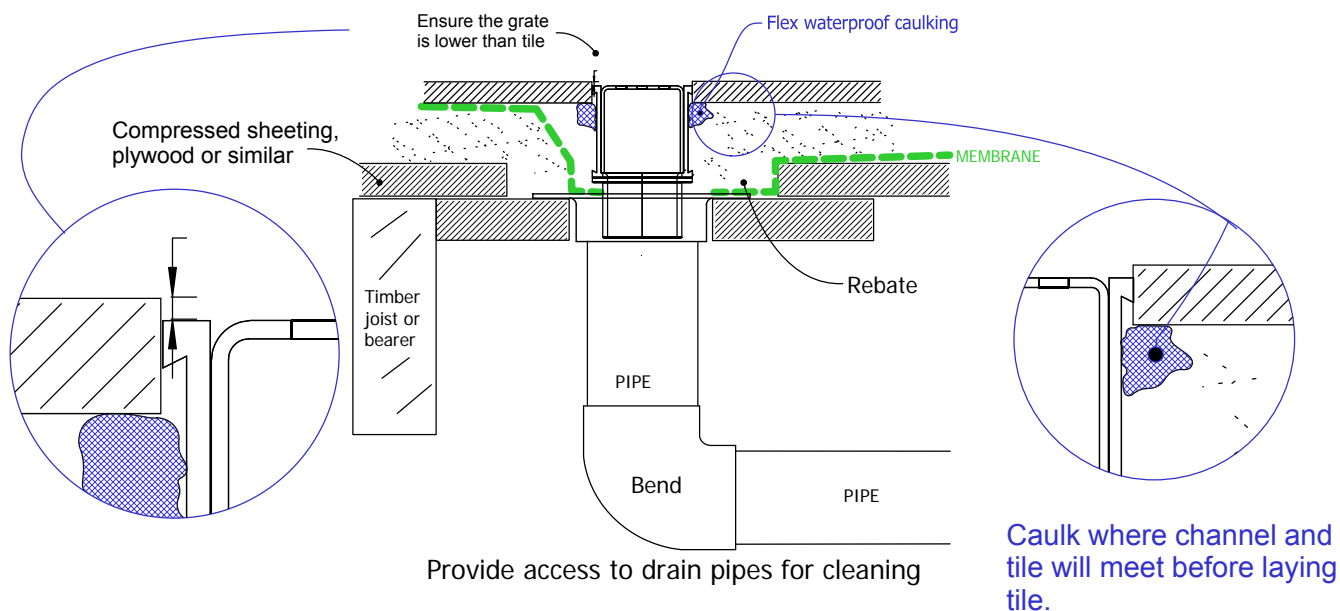

When 38MTL is running perpendicular to joist/bearer

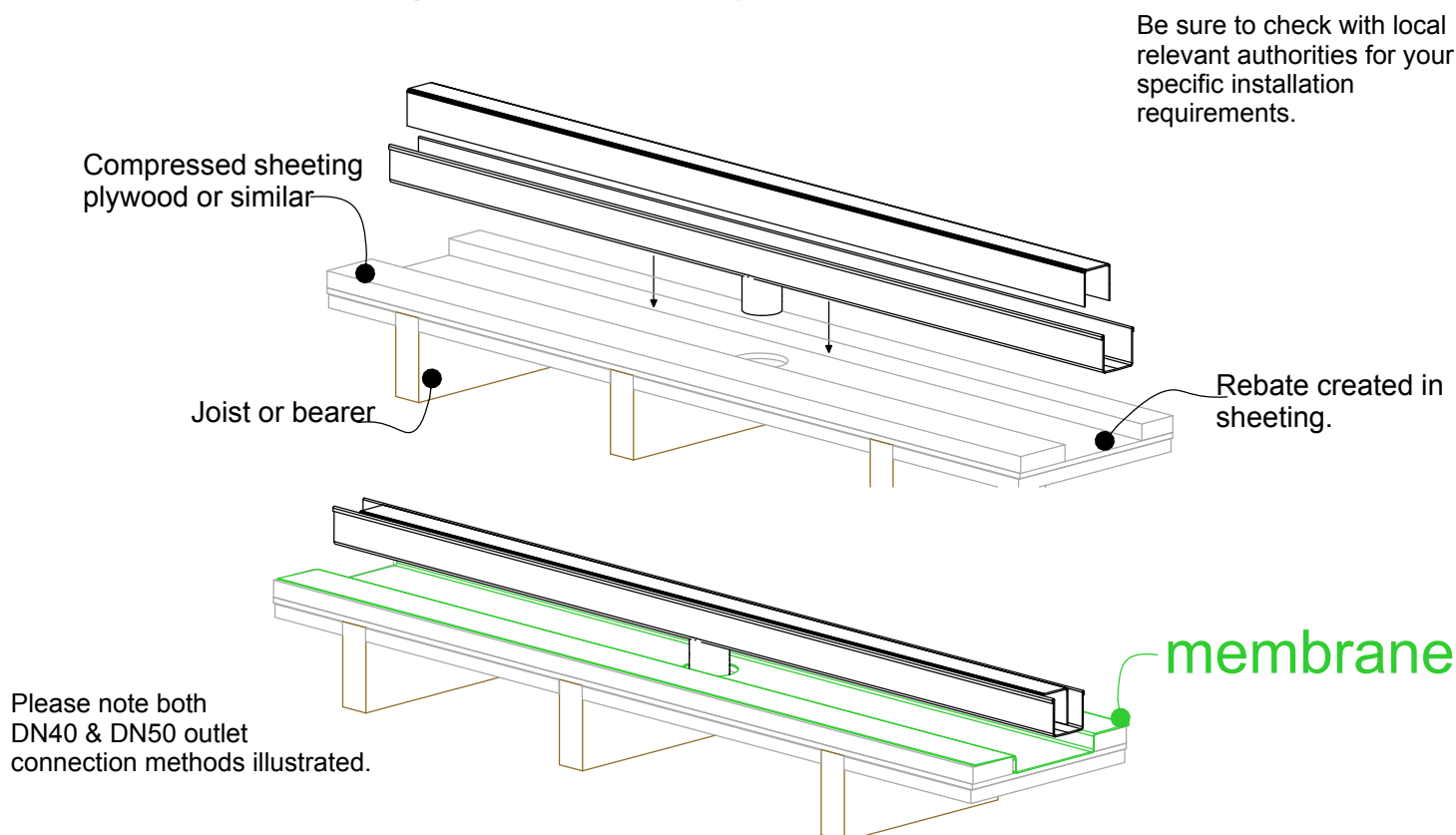

NOTE: For exterior application allow for expansion of 1mm per metre by using quality suitable flexible sealant on channel joins. Use PVC solvent cement and primer for ends and outlets.



38MTL Against Wall

For 38ARi409MTL, 38PSi40MTL and 38PHi40MTL

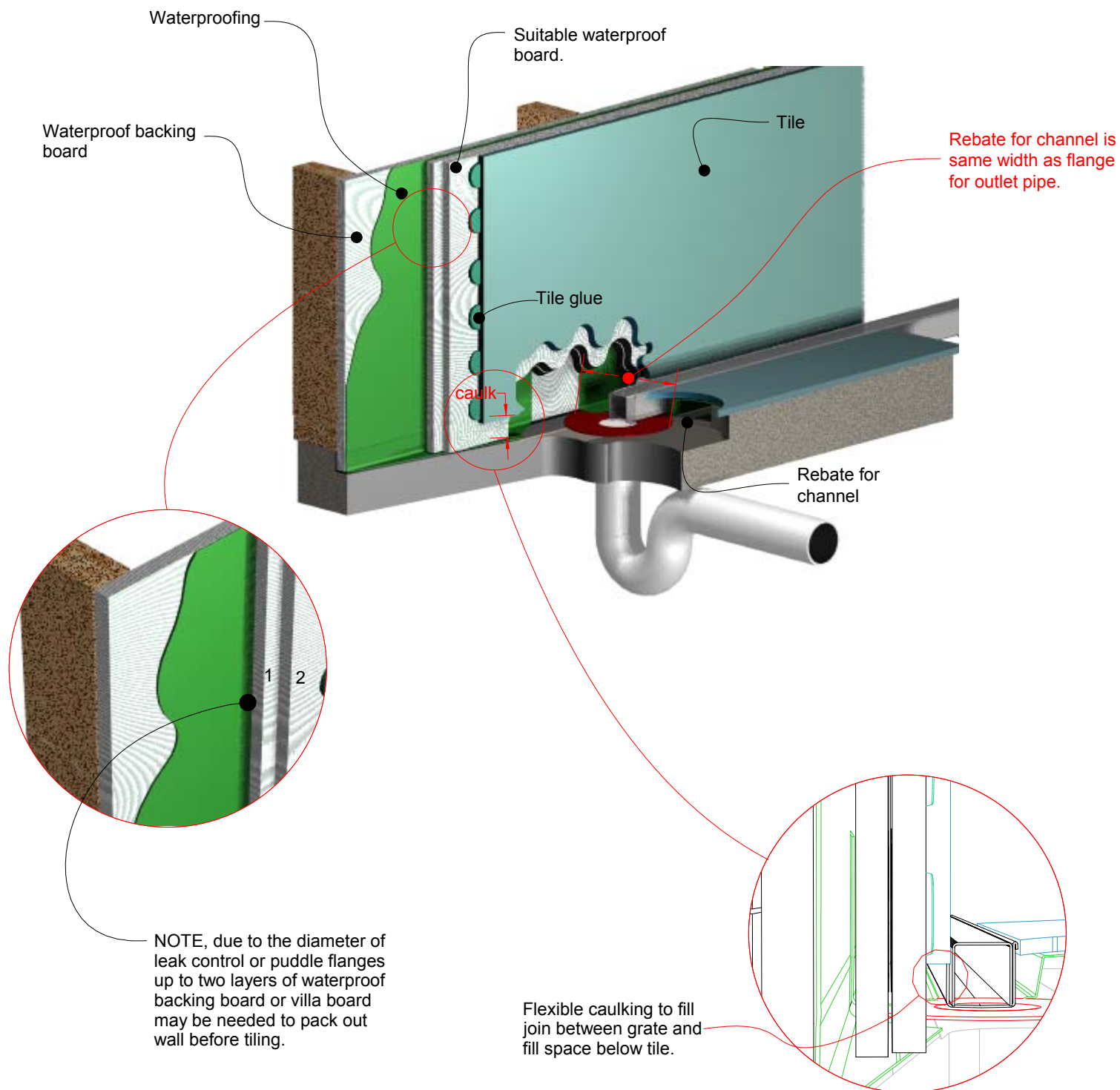



38PSi40MTL

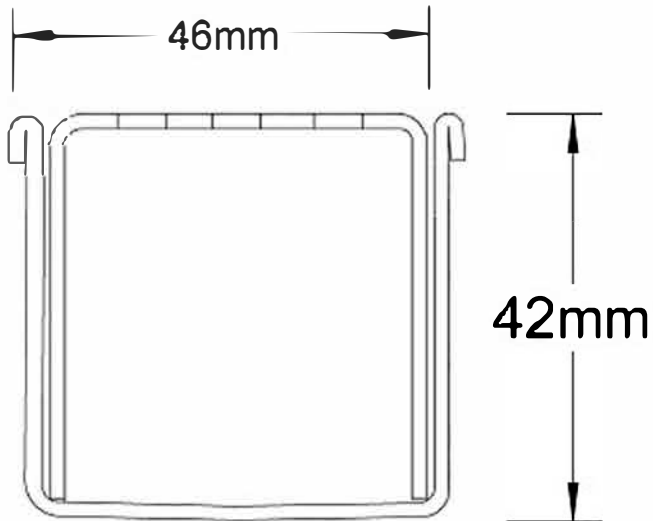

Drain 1

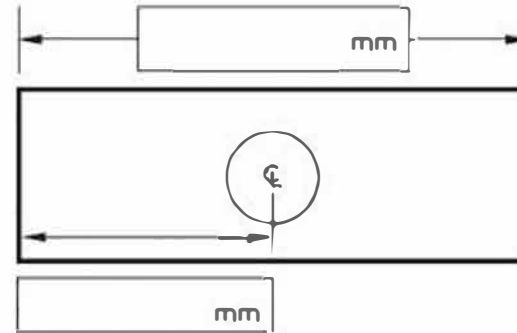

Outlet Size

- ☐ 25mm
- ☐ 32mm

Drain 2

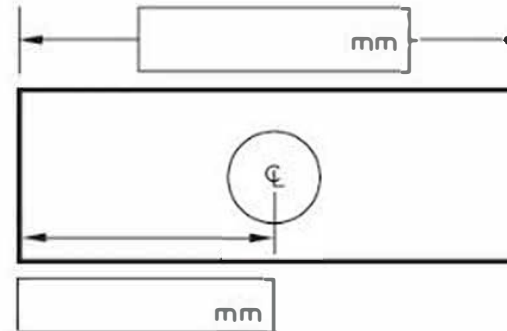

Outlet Size

- ☐ 25mm
- ☐ 32mm

Drain 3

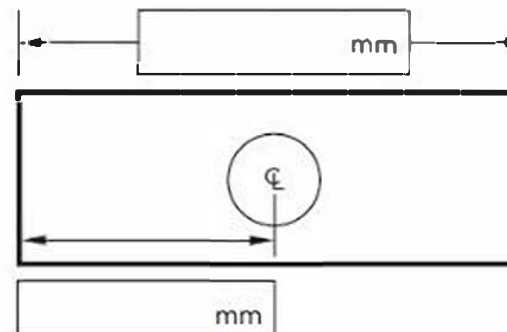

Outlet Size

- ☐ 25mm
- ☐ 32mm



WaterMark

Level 2 Licence WMKT 21249

Visit **stormtech.com.au**



StormtechTM

22 Norfolk Avenue, South Nowra, NSW 2541 Australia

Phone 1300 653 403 Email info@stormtech.com.au

